

# PARKING MAP AND CAMPUS TRANSIT ROUTES

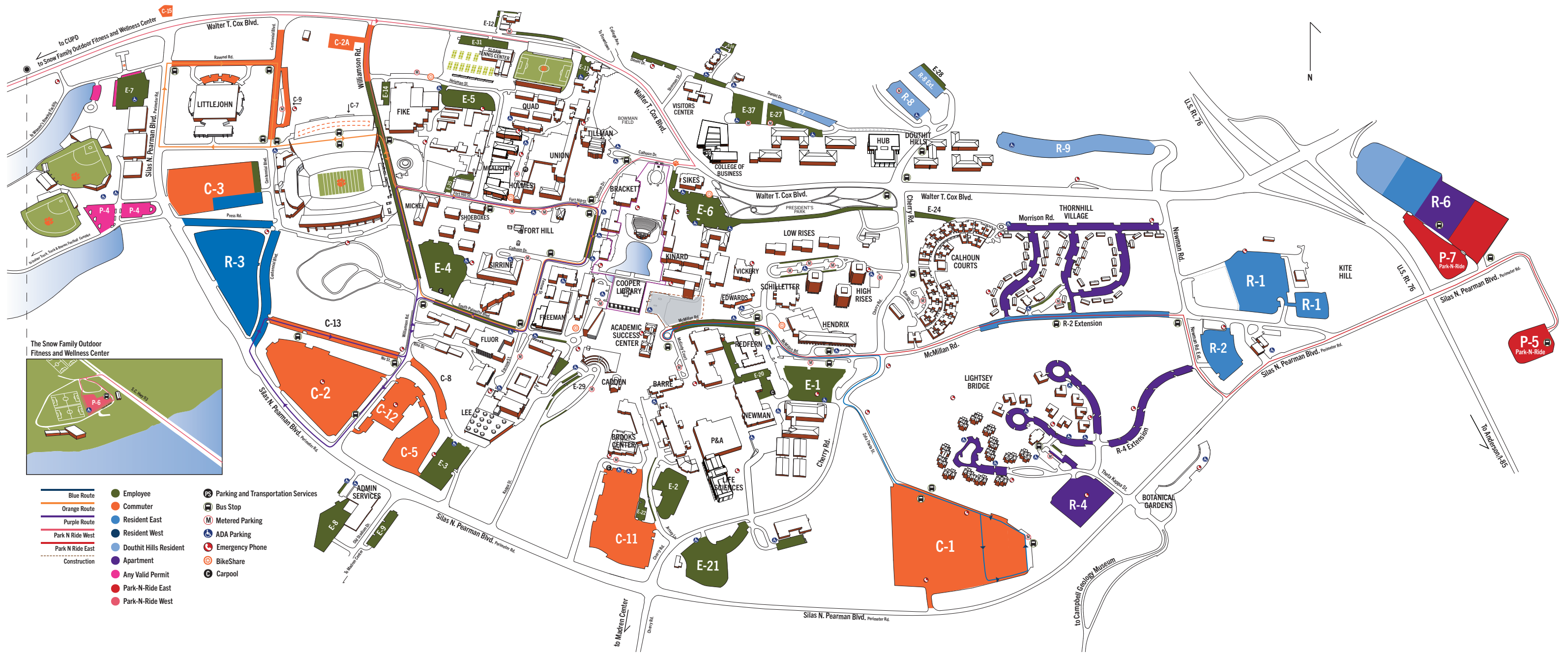

For more information: [clemsun.edu/parking](http://clemsun.edu/parking);  
864-656-2270; [parking@clemsun.edu](mailto:parking@clemsun.edu)

Follow us: [@clemson\\_parking](https://www.instagram.com/clemson_parking) for parking closures and transit changes.



# PARKING AND TRANSPORTATION SERVICES

## CONNECT WITH US TODAY!

- Push Notifications in the my.Clemson app
- @clemson\_parking on Instagram and Twitter
- @cuparkingandtransportation on Facebook
- Email parking@clemson.edu
- Call us at 864-656-2270

## NEED TO VISIT THE OFFICE?

Book an appointment at [clemson.edu/parking](http://clemson.edu/parking) so we can be prepared for your visit and serve you faster!

## PERMIT GUIDELINES

### VISIT [CLEMSON.EDU/PARKING/PERMITS](http://CLEMSON.EDU/PARKING/PERMITS) FOR FULL DETAILS

Everyone (excluding visitors who park in metered spaces) must obtain and display a permit to park anywhere on campus at any time. Short-term and temporary permits are available for those with short-term business on campus or for students who must switch out cars for any reason, e.g. using their parents' car. This makes you a CU Permit Holder.

- Rules are enforced year-round, including days when classes are not in session.
- Any vehicle, person or permit with three or more past-due citations may not park on campus and is subject to tow.
- If you park anywhere other than a marked space, your vehicle may be towed.
- Towed vehicles may be retrieved from Parking Services during business hours or after hours from the CU Police Department.
- Clemson operates on revised parking regulations on home football game days. See [clemson.edu/parking/football](http://clemson.edu/parking/football) for details.
- Towing begins 2 hours prior to Brooks Center events from logo marked spaces (known as Patron's row) within C-11. The marquee at the entrance of C-11 will be updated for each event.
- Any person to whom a decal has been issued shall remove the decal from the vehicle when the vehicle is sold or traded. Failure to do so can result in citations being automatically linked to your account.

Visit [clemson.edu/parking/permit](http://clemson.edu/parking/permit) to read the following in their entirety:

- Parking Rules and Regulations
- Permit Placement
- Manage My Account (view citations, pay citations, appeal citations)

## ACCESSIBLE PARKING

CU Permit holders who display a state-issued disability parking permit are required to register the permit with Parking and Transportation Services (PATS) office prior to use on campus. CU Permit Holders are required to purchase and display a campus parking permit, even when displaying an ADA permit. Contact PATS to register your ADA permit.

Student temporary disability permits, valid up to four weeks, may be obtained with prior approval from Student Accessibility Services (SAS). PATS does not review any medical documentation. To obtain approval, please first call SAS at 864-656-6848 or visit them in Suite 439 in the Class of '56 Academic Success Center.

Employee temporary disability permits may be obtained with prior approval from the Office of Access and Equity. PATS does not review any medical documentation. To obtain approval, call them at 864-656-3553 or visit them in 223 Brackett Hall.

## DAILY PARKING PERMITS

Students, faculty and staff who occasionally drive to campus may purchase daily parking permits for \$3/day when vehicle access is needed. Purchase online at [clemson.edu/parking](http://clemson.edu/parking).

## METERED PARKING

Visitors and CU permit holders (CUPH) must pay to park in designated multi-space metered areas under these guidelines:

- Everyone (excluding visitors who park in metered space) must obtain and display a permit to park anywhere on campus at any time.
- Payment is required by all users 7 a.m.-10 p.m., seven days a week, using cash, credit or pay by phone (using the Flowbird app).
- Visitors - No permit required: "Three-Hour Visitor Meter Limit" or as otherwise posted.
- CUPH: park for the "One-Hour CU Permit Limit" or as otherwise posted. Note: some meters are for "Visitors Only" and may not be used by a CUPH.

## MOTORCYCLE/MOPED

- Everyone must obtain and display a parking permit to park a motorcycle or moped anywhere on campus at any time.
- Motorcycles and mopeds may only park in designated motorcycle and moped parking areas.

ON MOTORCYCLES, THE DECAL SHOULD BE PERMANENTLY AFFIXED TO THE LEFT FRONT FORK. ON MOPEDS, THE DECAL SHOULD BE PERMANENTLY AFFIXED TO THE REAR WHEEL COVER.

## KEEP YOUR VEHICLE INFO UP TO DATE

For your parking permit to be valid, your vehicle information (license plate number, make, and model) must be accurate and linked to your permit. Wrong vehicle information may result in a parking citation or tow.

## SUSTAINABILITY INITIATIVES

### CARPPOOL PROGRAM

Clemson University students, faculty and staff with similar schedules at least four days per week may apply for the carpool program. Perks include:

- Dedicated, preferred parking
- Reduced parking permit fees
- FREE permits for groups of three or more participants.

Visit [clemson.edu/parking](http://clemson.edu/parking) for permit guidelines, carpool group applications and more information.

### PARK-N-RIDE

East and West Park-N-Ride locations are available. Your assigned lot is based on the permit selected at the time of purchase. Your permit can be used to park on campus according to your parking regulations beginning at 4:30 p.m.-2 a.m. on weekdays and from 4:30 p.m. Thursdays until 7 a.m. Mondays. (Official Use permits are only valid during this time). When Park-N-Ride shuttles are suspended, your permit can be used to park on campus according to your permit regulations.

Visit [clemson.edu/parking/permit](http://clemson.edu/parking/permit) for complete parking regulations.

### EMPLOYEE LEV AND EV

The Employee Low Emission Vehicle (LEV) and Electric Vehicle (EV) programs are available to approved faculty and staff current parking permit holders. Program participants have access to dedicated spaces across campus.

Visit <https://www.clemson.edu/campus-life/parking/employees/lev.html> for an application, qualifications, and program details.

### ZIPCAR

Need a car? Borrow a Zipcar! Zipcar is an on-demand car sharing program. Simply register as a member, reserve a car online or on the app, unlock the car using your new Zipcard, and drive where you want. When you're done, return the car to the same location you picked it up.

Learn more and get started at [zipcar.com/Clemson](http://zipcar.com/Clemson).



### CLEMSON BIKESHARE

Transform the way you travel with Clemson BikeShare, the campus bike sharing community that serves students, faculty and staff 24/7. Check out a bike, go for a ride and check the bike back in at any station unlimited times during your membership. The first two hours of each ride are free! Use the my.clemson app to view station locations and available bikes in real time.

Visit [Clemson.Bcycle.com](http://Clemson.Bcycle.com) to join. Download the Bcycle app to unlock the bikes.

## CAMPUS TRANSIT SERVICES

VISIT [CLEMSON.EDU/PARKING/TRANSIT](http://CLEMSON.EDU/PARKING/TRANSIT) FOR FULL DETAILS

### CAMPUS ROUTES

(Mon-Fri, 7:30 a.m.-5:30 p.m.)

Blue Route: 12-min service  
Orange Route: 8-min service  
Purple route: 8-min service



### PARK-N-RIDE ROUTES

(Mon-Thurs, 7 a.m.-6 p.m.)

East PnR (P-5/P-7 to Academic Success Center): 15-25-min service; West PnR (P-6 to Brackett Hall): 20-min service

### NIGHTTIME TIGER TRANSIT

(Mon-Thurs, 6 p.m.-2 a.m.; Fri-Sun, 6 p.m.-6 a.m.)

On-demand service to/from any on campus location  
Request a ride using the TransLoc app.

### RESEARCH PARK ROUTE

(Mon-Fri, 8 a.m.-6 p.m.)

Departs Edwards Hall on the hour (:00) and departs the Anderson Research Park at the bottom of the hour (:30). Research Park stops include Library depot, CCIT's IT Center, Rich Lab and Advanced Materials Research Lab (AMRL).

### TIGER COMMUTE

(Mon-Fri 6:20 a.m.-9 p.m.)

Bus service connecting Clemson at the Academic Success Center to CU-ICAR campus in Greenville with a stop in Easley.

Connect at CU-ICAR to Greelink routes for access to downtown Greenville, Greenville One building, Patewood Medical Campus, University Center and Haywood Mall.



### CLEMSON AREA TRANSIT

Free transit service around the Clemson area to campus, grocery stores, housing complexes and more.

Visit [catbus.com](http://catbus.com) for complete schedules.

### RED ROUTE

(Seven days a week, 6:50 a.m. - 3 a.m.)

Connecting Clemson and Central to Clemson University. Service times vary from every 15 minutes to 60 minutes depending on time of day and day of week. Follow the bus in real time using the TransLoc app.

### PENDLETON ROUTE

(Mon-Fri, 6:45 a.m. - 6:45 p.m.)

Connecting Clemson University with Tri-County Technical College and downtown Pendleton.

### GREENLINK

Greenville's public transit system which connects to CU-ICAR.

Visit [greenvillesc.gov/151/Greenlink-Transit](http://greenvillesc.gov/151/Greenlink-Transit) for complete schedules